

# method of operation



  
At least 6  
links  
of chain  
below the  
clamp

Confirm that the load being lifted is suitable. It must have a lifting hole of  $\text{Ø}40\text{mm}$  for the 8-10mm chain and  $\text{Ø}62\text{mm}$  for the 16mm chain, 250mm (10") down from the top edge. The SWL of all lifting equipment must be observed. Insert the lifting chain correctly (no twists, knots etc) through the lifting hole in the load and secure with the chain clamp. To slide the Chain Clamp along the chain, depress the trapping pin assembly by hand. When the Chain Clamp is in the desired position, release the trapping pin, locking the chain clamp in position.

## Safety Notes:

Ensure the chain type is the correct size for the chain clamp. 8mm chain for the 8mm Chain Clamp and 10mm Chain for the 10mm Chain Clamp etc. If in any doubt, contact Dawson Construction Plant.

The Chain Clamp must have at least 6 links of chain below it when in the installed position.

When the Chain Clamp is in position, check the trapping pin assembly returns to its fully out position. This ensures the Chain Clamp is securely locked on the chain. Give the Chain Clamp several firm tugs to double check. With the new style clamp, the safety latch can be visually check to ensure the latch has return to its fully out position.

When pile handling commences, ensure the Chain Clamp is not snagged or contacted by obstructions. It should only be in contact with the chain and the pile being handled.

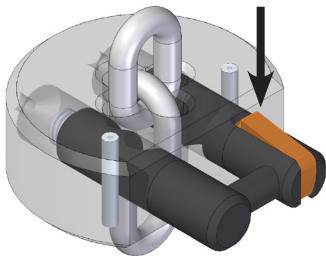

On new style clamps, press and hold down safety catch

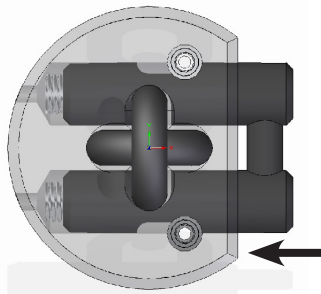

Trapping pin depress to enable the clamp to slide along the chain

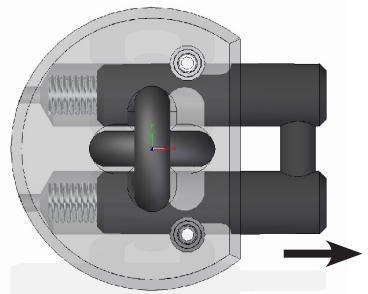

Trapping pin released locking the chain clamp in position

# cont'd - method of operation

## EXTRA NOTE FOR VIBRATORY SHEET PILE DRIVING USE



### Pile Installation

Check which way around the pile has to be lifted before inserting the lifting chain – was the previous pile pitched left or right handed? Insert the lifting chain correctly (no twists, knots etc) through the lifting hole in the pile and secure with the chain clamp. Allow enough free chain length for the pile to rotate to vertical during the lifting process without jamming against the underside of the clamp body. If this happens the chain will be overloaded, may subsequently break and allow the pile to fall – this is a severe hazard to all site personnel and must be avoided at all times. Do not allow too much chain so that the top of the pile hangs too far away from the clamp when it is raised to the vertical – this will make it difficult to engage the pile in the clamp.

The Chain Clamp should stay secured in position until the pile has been driven to the desired level. When the vibrator has stopped, and it is safe to do so, remove the Chain Clamp and lifting chain from the pile.



### Pile Extraction

Attach the Chain Clamp as for pile installation.

When the pile has been extracted, Hold the pile on the ground and release the jaws. Raise the vibrator off the pile slowly ensuring that there is no snatch on the lifting chain. Slowly lower the pile towards the ground.

**UNDER NO CIRCUMSTANCES SHOULD A PILE BE PULLED USING THE CHAIN ONLY!!**

**ALWAYS READ AND UNDERSTAND THE OPERATORS MANUAL FOR THE PILE DRIVING EQUIPMENT BEING USED.**

# safety check list

## 1. PRE-INSTALLATION CHECKS

Prior to installing a Chain Clamp onto any steelwork, check the following:

- a. Establish the weight of the lift involved and check against the SWL of the equipment.
  - b. Ensure the lifting hole is at the correct distance relative to the top of the load.
  - c. The Safe Working Load rating of is based on a purely tensile (vertical) load.
2. Do not modify the Chain Clamp or any part of the lifting apparatus.  
Keep the burning torch well clear!
  3. Keep the mechanism well lubricated with a light oil (WD40type).
  4. The Chain Clamp should be visually inspected before each and every lift. This is in addition to the formal inspections and maintenance points listed in this manual.
  5. Ensure appropriate Personal Protection Equipment is used, including gloves.