



## Block Grab Operating Instructions

Mechanical grabs can be used off any suitable lifting device including cranes, hoists and fork trucks. The lifting device must have sufficient lifting capacity to lift at least the weight of the grab plus the grab's maximum permitted load (SWL).

The grab should be securely attached to the lifting device by its central lifting eye.

Each grab is fitted with a locking mechanism which automatically holds the grab open between lifts.

When a load is to be lifted the grab should be lowered smoothly and gently down onto the load so that the location rollers/landing frame take the weight of the grab on top of the load. During lifting operations the jaws should not be allowed to make contact with the ground. When transporting a layered pack e.g. blocks, bricks, kerbs, the pack should be banded and the jaws should grip the lowest layer of the pack no further than 1/3 rd of the way up the block from the ground otherwise the load may fall, see below:

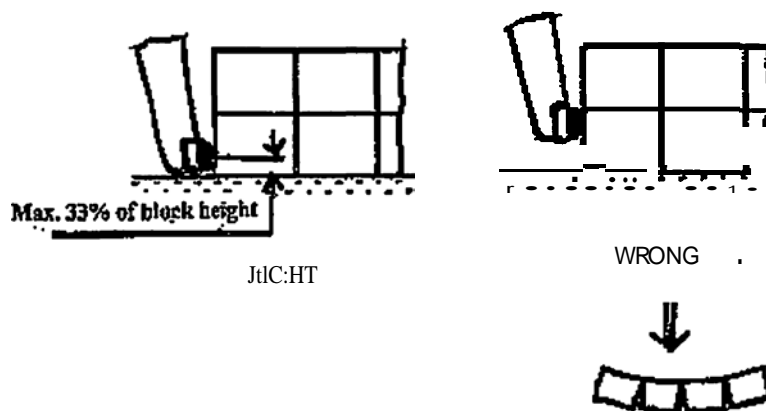

When the grab is fully lowered onto the load the locking mechanism is activated and when next lifted the grab will close around the load, gripping it securely due to the effects of gravity. The lifting action should be smooth at all times, without jerkiness or sudden changes in crane direction which may cause the load to swing or temporarily reduce the effects of gravity which will decrease the gripping force.

When putting down a load the grab should be smoothly lowered so that it is fully open - in this way the locking mechanism is activated and the grab held open by the locking hooks. It can then be lifted clear from the load.

Before each lift care should be taken to ensure that the jaws and load (at the gripping point) are clean and free from dirt, grease, ice etc or anything that could decrease the gripping force between jaws and load.

A safety net should always be used where a grab is to be used in a situation which requires it (advice can be obtained from the local health and safety officer). Some grabs are supplied as standard with fittings for a safety net. However, all the grabs can be modified to take a safety net if required. Refer to dealer for further advice.

A grab should only be used to handle products within its specified operating range - see Technical Specification details.

#### Use of Grab When Lifting Product Packs

When lifting product packs the grab jaw length should be sufficient so that outer blocks, kerbs, paving slabs or similar products do not protrude outside of the jaws.

Product packs should be picked up so that the jaws grip the blocks, kerbs, paving slabs and similar products end-on. Failure to do this may result in the products sliding against each other and falling.

#### Use of Grab When Lifting Individual Stones

When lifting individual stones the grab should always be lowered onto the centre of the stone so that when lifted the load and grab will be evenly balanced and the jaws of the grab will be parallel to the ground. Individual stones should always be gripped at a point where the sides are parallel.

#### Guidance Notes

The removable jaws should be fitted so that the rubber pads are not directly on the ground (see below). Generally, the jaws should be fitted with the empty grab at rest on a firm, even surface. However, in some circumstances it may be necessary to lift the empty grab a very small distance off the ground in order to facilitate fitting the jaws. At no point should the grab be allowed to become unstable and the operator should not place any part of his body underneath the grab when fitting the jaw. Ensure that the jaws are securely fastened. If the grab is on a pallet it should be removed and placed on the ground prior to fitting the jaws.

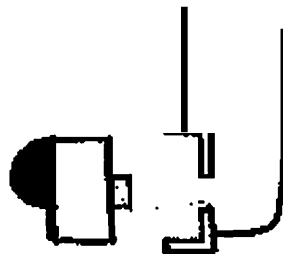

Different jaw lengths are available where required. If jaw lengths greater than 1200mm are fitted this may affect the stated SWL of the grab - consult your dealer.

The location rollers should be adjusted, so that when resting on top of the load the jaws are correctly placed on the load. Both location rollers should be fixed at the same height. Height should be adjusted with the grab at rest on even ground unloaded.



Fareham 01329 828082

Uckfield 01825 744052

[www.promechhire.co.uk](http://www.promechhire.co.uk)