



Operating Instructions

Translation of original operating instructions

GULLY-LIFTER

Contents

Contents	2
1 EC-Declaration of Conformity	3
2 Safety.....	4
2.1 Safety symbols.....	4
2.1 Explanation of basic concepts	4
2.2 Definition skilled worker / specialist	4
2.3 Safety Marking.....	5
2.4 Personal safety requirements.....	6
2.5 Protective equipment	6
2.6 Accident prevention	6
2.7 Function Control	6
2.7.1 General	6
2.8 Safety procedures	7
2.8.1 General	7
2.8.2 Hydraulic excavator and other lifting equipments.....	7
3 General.....	8
3.1 Authorized use.....	8
3.2 Survey and construction	9
3.3 Technical Data	9
4 Installation.....	10
4.1 Mechanical connection.....	10
4.1.1 Suspension lug	10
5 Adjustments	11
7 Operation	12
7.2 Picture of the automatic release	13
8 Maintenance and care	14
8.1 Maintenance.....	14
8.2 Repairs	14
8.4 Safety procedures	16
8.5 Hints to the identification plate	17
8.6 Hints to the renting/leasing of PROBST devices.....	17

1 EC-Declaration of Conformity

Declaration of conformity

Description: GULLY-LIFTER
Order-Nr.: 5400.0038
Manufacturer: Probst GmbH
Gottlieb-Daimler-Straße 6
D-71729 Erdmannhausen
info@probst-handling.de www.probst-handling.de

Complies with the following provisions applying to it

EC-machinery directive 2006/42/EG

Applied harmonized standards in particular

EN ISO 12100-1 (ISO 12100-1)

Safety of machinery; Basic concepts, general principles for design,
Part 1: Basic terminology, methodology

EN ISO 12100-2 (ISO 12100-2)

Safety of machinery; basic concepts, general principles for design;
Part 2: principles and specifications

DIN EN ISO 13857

Safety of machinery — Safety distances to prevent hazard zones being reached by upper and lower limbs (ISO 13857:2008)

DIN EN 349 (ISO 13854)

Minimum distance to avoid squeezing any parts of the body

Authorized person for EC-dokumentation:

Name: J. Holderied
Address: Probst GmbH; Gottlieb-Daimler-Str. 6; D-71729 Erdmannhausen

Signature, informations to the subscriber:

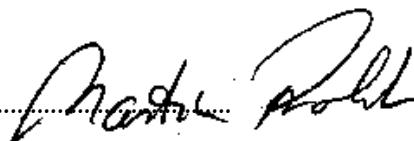

Erdmannhausen, 19.02.2016.....

(M. Probst, Managing director)

A handwritten signature in black ink, appearing to read "M. Probst", written over a dotted line.

2 Safety

2.1 Safety symbols

	<p>Danger to life! Identifies imminent hazard. If you do not avoid the hazard, death or severe injury will result.</p>
	<p>Hazardous situation! Identifies a potentially hazardous situation. If you do not avoid the situation, injury or damage to property can result.</p>
	<p>Prohibition! Identifies imminent a prohibition. If you do not avoid the prohibition, death and severe injury, or damage to property will result.</p>

2.1 Explanation of basic concepts

Gripping range:	<ul style="list-style-type: none"> • specify the minimum and maximum product measurements of the gripping good, which can be gripped with this device.
Gripping good (s):	<ul style="list-style-type: none"> • is the product, which will be gripped or transported.
Opening width:	<ul style="list-style-type: none"> • consists of the gripping range and the measure to drive over the gripping good. <i>gripping range + measure to drive over the gripping good = opening width</i>
Immersion depth:	<ul style="list-style-type: none"> • is the maximum gripping height of gripping goods, conditional of the height of the gripping arms of the device.
Device:	<ul style="list-style-type: none"> • is the description for the gripping device.
Product dimensions:	<ul style="list-style-type: none"> • Are the dimensions of the gripping good (e.g. length, breadth, height of the product).
Dead weight:	<ul style="list-style-type: none"> • is the own weight (without gripping good) of the device.
Carrying capacity/working load limit (WLL):	<ul style="list-style-type: none"> • specify the maximum possible load of the device (for lifting of gripping goods).

2.2 Definition skilled worker / specialist

Only skilled workers or specialists is it allowed to carry out the installation,- maintenance, - and repair work on these device!

Skilled workers or specialists must have for the following points (if it applies for these device), the necessary professional knowledge.

- for mechanic
- for hydraulics
- for pneumatics
- for electrics

2.3 Safety Marking

PROHIBITION SIGN

Symbol	Meaning	Order-No.:	Size:
	It is not allowed to be under hanging loads. Danger to life!	2904.0210	30 mm
		2904.0209	50 mm
		2904.0204	80 mm

WARNING SIGN

Symbol	Meaning	Order-No.:	Size:
	Danger of squeezing the hands.	2904.0221	30 mm
		2904.0220	50 mm
		2904.0107	80 mm

REGULATORY SIGN

Symbol	Meaning	Order-No.:	Size:
	Each operator must have read and understood the operating instructions (and all safety instructions).	2904.0366	30x57 mm
		2904.0365	50x95 mm

2.4 Personal safety requirements



- Each operator must have read and understood the operating instructions.
- Only qualified, authorized certificated personal is allowed to operate the device and all devices which are connected (lifting equipment).



- The manual guiding is only allowed for machines with handles.

2.5 Protective equipment

The protective equipment must consist, according to the safety regulations of the following parts:

- Protective clothing
- Safety gloves
- Safety shoes

2.6 Accident prevention



- The workplace has to be covered for unauthorized persons, especially children.
- Take care in case of thunderstorm!



- The workplace has to be sufficiently illuminated.
- Take care with handling wet, dirty and not solidified components.

2.7 Function Control

2.7.1 General



- Before using the device check the functions and the working condition.
- Maintenance and lubrication are only permitted when device is shut down!



- Do not use the device, until all faults which can cause safety hazards are removed.
- If there are any cracks, splits or damaged parts on any parts of the device, **immediately** stop using it.



- The operating instructions must be available at the workplace every time.
- Do not remove the data-plates of the machine.
- Unrecognisable information signs must be replaced.

2.8 Safety procedures

2.8.1 General



- The use of the device is only permitted in proximity to the ground. Do not swing it over peoples heads.
- The manual guiding of is only allowed for devices with handles.
- The operator is not allowed to leave the control unit as long as the device loaded with load. The load must always be in the range of vision of the operator.



- While using the device is the stay of persons in the working area forbidden. Except it is indispensable. Caused of the way of using the device, e.g. if the device must be leaded by hand.
- While using the device be sure that there are no persons in the working area. **Danger to Life!**
- The device must never be subjected to a force acting in a lateral direction due to diagonal pulling.
- Do not use the device to jerk seized products.
- Do not lift any components off-centre, because that **could fall down**.
- The device should not be opened if the opening path of the gripping arm is blocked by a resistance (e.g. other concrete blocks or the like)!
- The carrying capacity/working load limit (WLL) and the nominal width of the device are not allowed to cross over.
- The jerky lifting and lowering of the device with and without load. e.g. caused through driving fast with the support frame/lifting device over uneven grounds is **forbidden**. Because the gripping good could **fall down**. Unchecked movements of the device.

2.8.2 Hydraulic excavator and other lifting equipments



- Hydraulic excavator and other lifting equipments have to be in good, safe working condition.
- Only authorized, certificated and qualified personnel is allowed to operate the excavator and other lifting equipments.
- The operator staff must have all the necessary qualifications.



- **Take care that the maximum capacity of the hydraulic excavator and other lifting equipments is not exceeded.**

3 General

3.1 Authorized use

The device (GULLY-LIFTER) is specially designed for gripping and installation of concrete gully-pots standing upside down (as per BS 5911-6) with outside diameter between 485 and 560mm (inner Ø 19" and 22").

This device is equipped with:

- *two fixed arms and one movable arm with rubber
- * automatic release for the fully automatic switch over from „full“ to “empty

Do not exceed the carrying capacity/working load limit (WLL) and the dimensions of the device (see “Technical Data”).



- The device is only designed for the use specified in this documentation.
- Every other use is not authorized and is forbidden!
- All relevant safety regulations, corresponding legal regulations, especially regulations of the declaration of conformity, and additional local health and safety regulations have to be observed.



Prior to every operation the user must ensure that:

- the equipment is suited to the intended operation, the functioning and the working condition of the equipment is examined, and the loads are suitable to be handled.

Any doubts about instructions should be raised with the manufacturer prior to use.



ATTENTION: The use of this device is only permitted in proximity to the ground.



NOT ALLOWED ACTIVITIES:

Unauthorized alterations of the device and the use of any self-made additional equipment could cause danger and are therefore **forbidden!!**

The **carrying capacity/working load limit (WLL)** and the **nominal width** of the device are not allowed to cross over.

3.2 Survey and construction

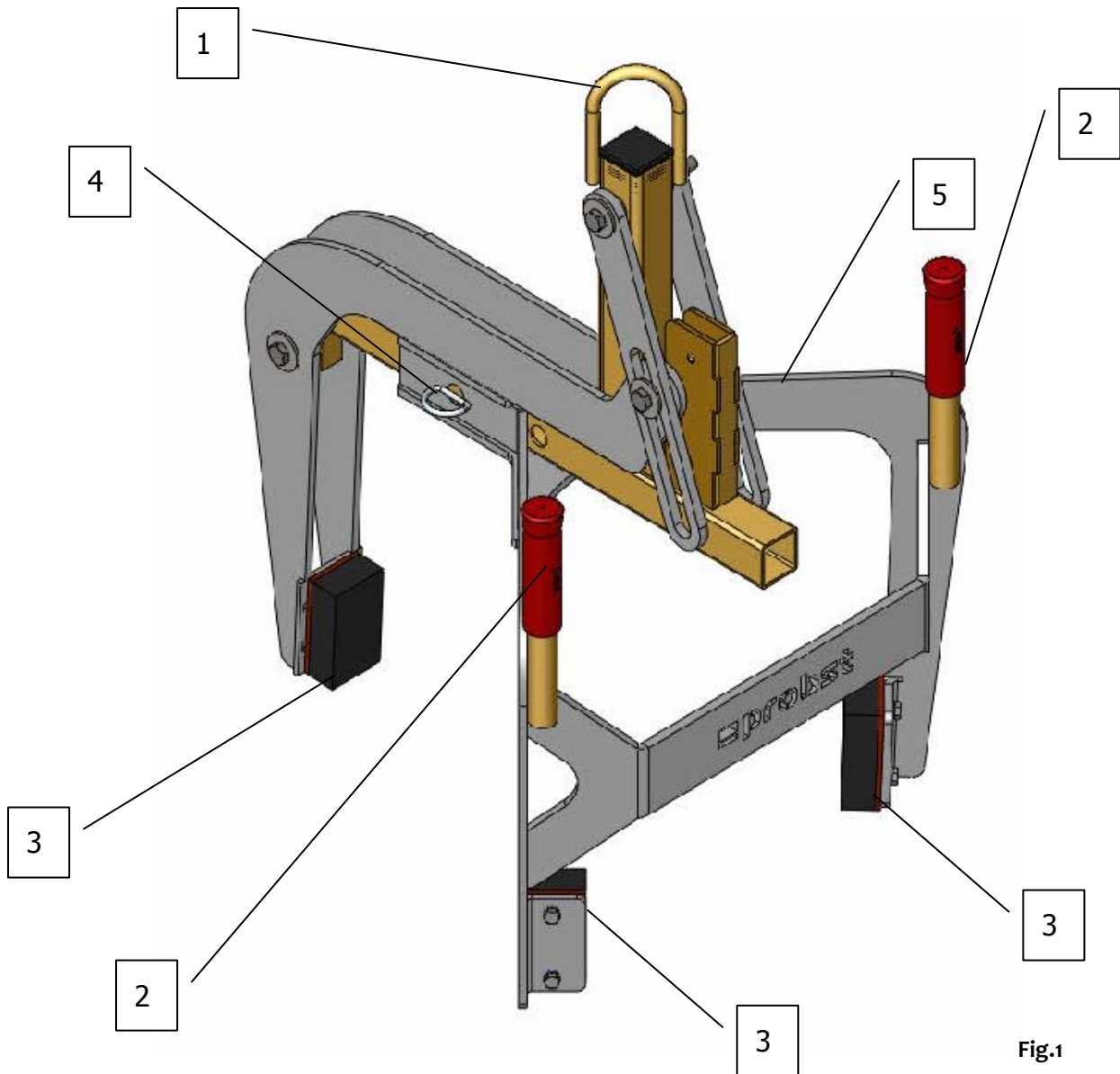

Fig.1

1	Suspension lug for lifting tackle (crane-hook, belt etc.) at support frame/lifting device (e.g. excavator)	4	Bolt with half ring (for gripping range adjustment)
2	Handle	5	Automatic release for the fully automatic switch over from „full“ to “empty”
3	Rubber gripper		

3.3 Technical Data

Type:	Carrying capacity/ working load limit (WLL)	Dead Weight
	300kg / 660lbs.	31 kg (68 lbs)

4 Installation

4.1 Mechanical connection

4.1.1 Suspension lug

- The device is equipped with a suspension lug and can be mounted on various support frames/lifting devices.



- Take careful that the suspension lug is safety joined with the crane hook and can not slip down.



- **The maximum carrying capacity/working load limit (WLL) of the support frame/lifting device is not allowed to exceed the dead weight of the device and the maximum load.**

5 Adjustments

6 Adjustment of the opening range

Before the product can be lifted and transported, the gripping range has to be adjusted to the dimensions of the product.

Otherwise is not ensured that the clamping force for the secure gripping of the gripping good is adequate and it could slide down!

- Release bolt with half ring (1), through pulling out of the splint (2).
- Pull the bolt with half ring (1) at the upper part and the opening range adjustment. Slide the rectangular tubes apart, until the opening range is about 5 cm greater than the product.
- Insert the bolt with half ring (1) again and safe it with the splint (2).



- Caution while adjusting of the gripping range. There is a danger of injuring the hands!
- Defective safety elements (splints) must be replaced absolutely!

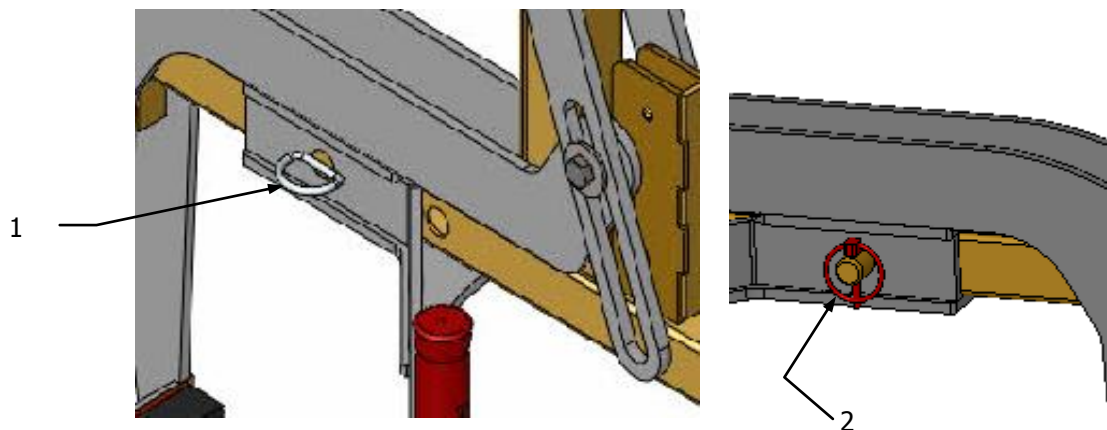

7 Operation

7.1 Operating for devices with automatic release

The device is connected to the lifting equipment/support frame (e.g. excavator).

Before lifting the device, the gripping range has to be adjusted.

The device is placed over the product, set down, the device closes round the product and it can be lifted.

Set down on the ground again, the device opens automatically, the automatic release locks it into position so that the device can be lifted without closing up.

Placed over the next product, the automatic release disengages itself and the product can be lifted.

The device therefore is a ONE-MAN-MACHINE.



Shut-down the device without lifting equipment/support frame only on even ground. The gripping arms must be opened enough, to ensure a secure standing of the device. Otherwise exists danger of overturning!

7.2 Picture of the automatic release

The device is mounted with a automatic release, that means the opening and closing of the gripping arms results through the set down and lifting of the device.

Pictures the positions of the automatic release

<p>1</p> <ul style="list-style-type: none"> • Device is lifted through the lifting equipment/carrier. • Gripping arms are opened. 	<p>2</p> <ul style="list-style-type: none"> • Device is set up on the gripping good. • Gripping arms are opened. 	<p>3 A</p> <ul style="list-style-type: none"> • Device is lifted through the lifting equipment/carrier. • Gripping good is clamped and can be transported to the destination.
<p>3 B</p> <ul style="list-style-type: none"> • With faulty switching, the change-over switch must be pushed back manually (e.g. with a screwdriver). ¹⁾ 	<p>4</p> <ul style="list-style-type: none"> • Device is set down with the gripping good (on the ground). • Gripping arms are opened. 	<p>5 / 1</p> <ul style="list-style-type: none"> • Device is lifted through the lifting equipment/carrier. • Gripping arms are opened. (laydown position of the device on the ground)

¹⁾ Otherwise there may be faulty switching and when setting down the load this can cause deformation or damage of the automatic release!
The jerky lifting and lowering of the device with and without load. e.g. caused through driving fast with the lifting equipment/carrier over uneven grounds is **forbidden**.

8 Maintenance and care

8.1 Maintenance



To ensure the correct function, safety and service life of the device the following points must be executed in the maintenance interval.

Used **only original spare parts**, otherwise the warranty expires.



For all maintenance services the device must be completely shut down!!!
For all operations you have to make sure, that the device will not close unintended.
Danger of injury!!!

MECHANICAL

SERVICE INTERVAL	Maintenance work
First inspection after 25 operating hours	<ul style="list-style-type: none"> Control and tighten all screws and connections. (The implementation is only allowed by an expert).
All 50 operating hours	<ul style="list-style-type: none"> Tighten all screws and connections (take care that the tightening torques according to the property class of the screws are observed). Check all joints, bolts, guidance's and gears for correct function, if necessary adjust or replace it. Check all Grippers (if available) for signs of wear. Grease all slidings (if available) when the device is in opened position with a spatula.
Minimum 1x per year (at rough conditions shorten the interval)	<ul style="list-style-type: none"> Check of all the suspension parts, bolts and straps. Check for corrosion and safety by an expert.

8.2 Repairs

- Only persons with the appropriate knowledge and ability are allowed to repair the device.
- Before the device is used again, it has to be checked by an expert.

8.3 Trouble shooting

ERROR	CAUSE	REPAIR
The clamping-power is not big enough, the load is slipping out		
(optional)	<ul style="list-style-type: none"> The grippers are worn 	<ul style="list-style-type: none"> Replace the grippers
(optional)	<ul style="list-style-type: none"> The maximum load is exceed 	<ul style="list-style-type: none"> Reduce the weight of. the load
(Adjustment of the gripping range) (optional)	<ul style="list-style-type: none"> The actual opening width is not correct 	<ul style="list-style-type: none"> Adjust the gripping range according to the load you want to transport
(Property of material)	<ul style="list-style-type: none"> The surface of the material is dirty or the material is not suitable / allowed for this device. 	<ul style="list-style-type: none"> Check the surface of the material or ask the manufacturer, if you the material is allowed for this device.
Unbalanced load		
	<ul style="list-style-type: none"> The device is not loaded symmetrically 	<ul style="list-style-type: none"> Adjust the position of the load
(Adjustment of the gripping range) (optional)	<ul style="list-style-type: none"> The adjustment of the gripping range is not symmetrical. 	<ul style="list-style-type: none"> Correct the adjustment of the gripping range
Automatic release does not work		
mechanical (optional)	<ul style="list-style-type: none"> Automatic release does not work 	<ul style="list-style-type: none"> Clean automatic release with high pressure-cleaner Oil the automatic release (never with grease) Correct faulty switching (→see chapter “Picture of the automatic release”) Change the inset of the automatic release

8.4 Safety procedures

- It is the contractors responsibility to ensure that the device is checked by an expert in periods of max. 1 year and all recognized errors are removed (→ see BGR 500).
- The corresponding legal regulations and the regulations of the declaration of conformity have to be observed!
- We recommend, that after checking the device the badge „Safety checked“ is put on the device. (Order-No.: 2904.0056+inspection sticker with date).
- You can receive these badges from us.



The check by an expert must be proved!

Device	Year	Date	Expert	Company

8.5 Hints to the identification plate



Type, serial-number and production year are very important for the identification of your device. If you need information to spare-parts, warranty or other specific details please refer to this information.

The maximum carrying capacity/working load limit (WLL)/is the maximum load which can be handled with the device. Do not exceed this carrying capacity/working load limit (WLL).

If you use the device in combination with other lifting equipment (Crane, chain hoist, forklift truck, excavator) consider the deadweight of the device.



Example:

8.6 Hints to the renting/leasing of PROBST devices



With every renting/leasing of PROBST devices the original operating instructions must be included unconditionally (in deviation of the users country's language, the respective translations of the original operating instructions must be delivered additionally)!

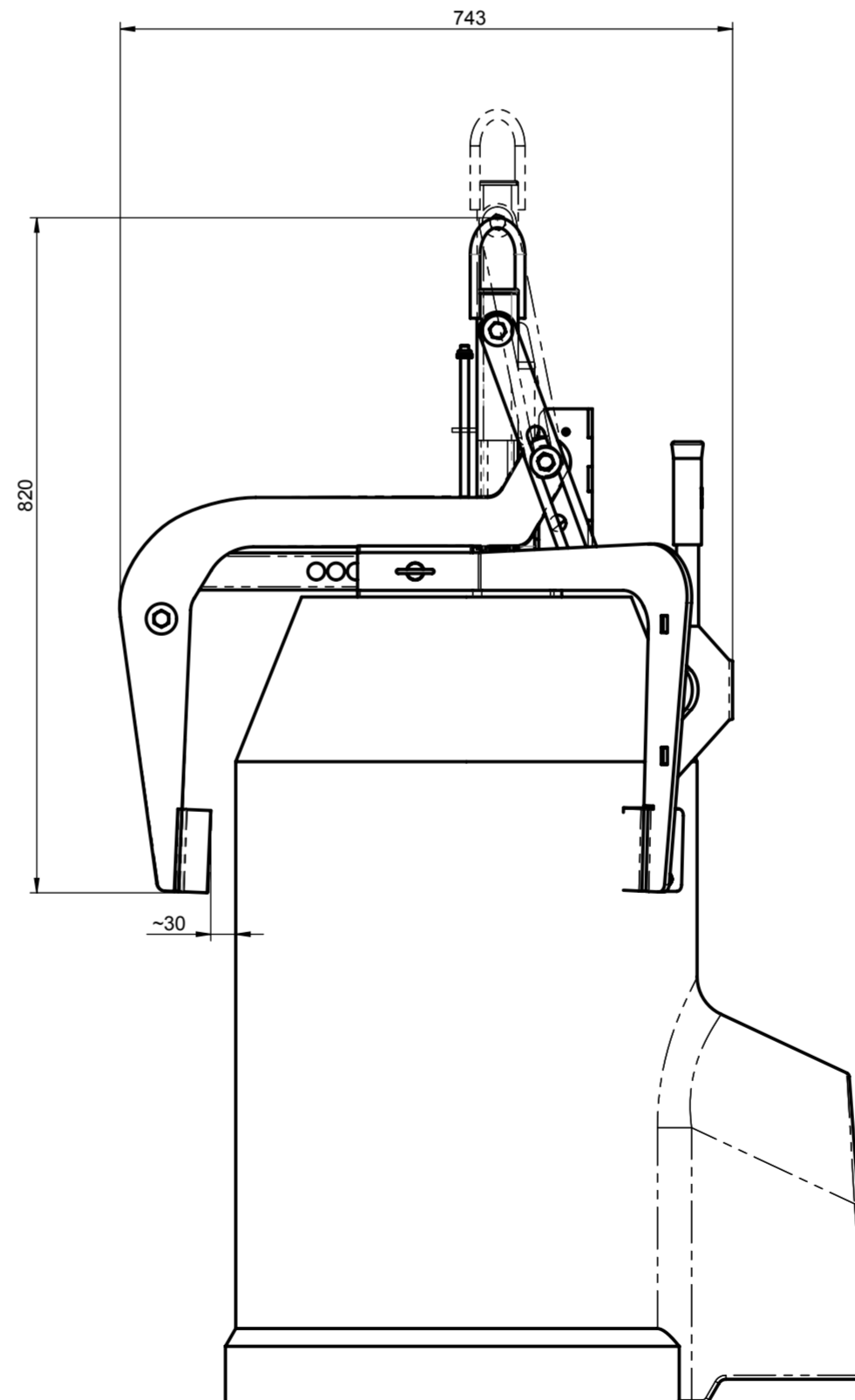
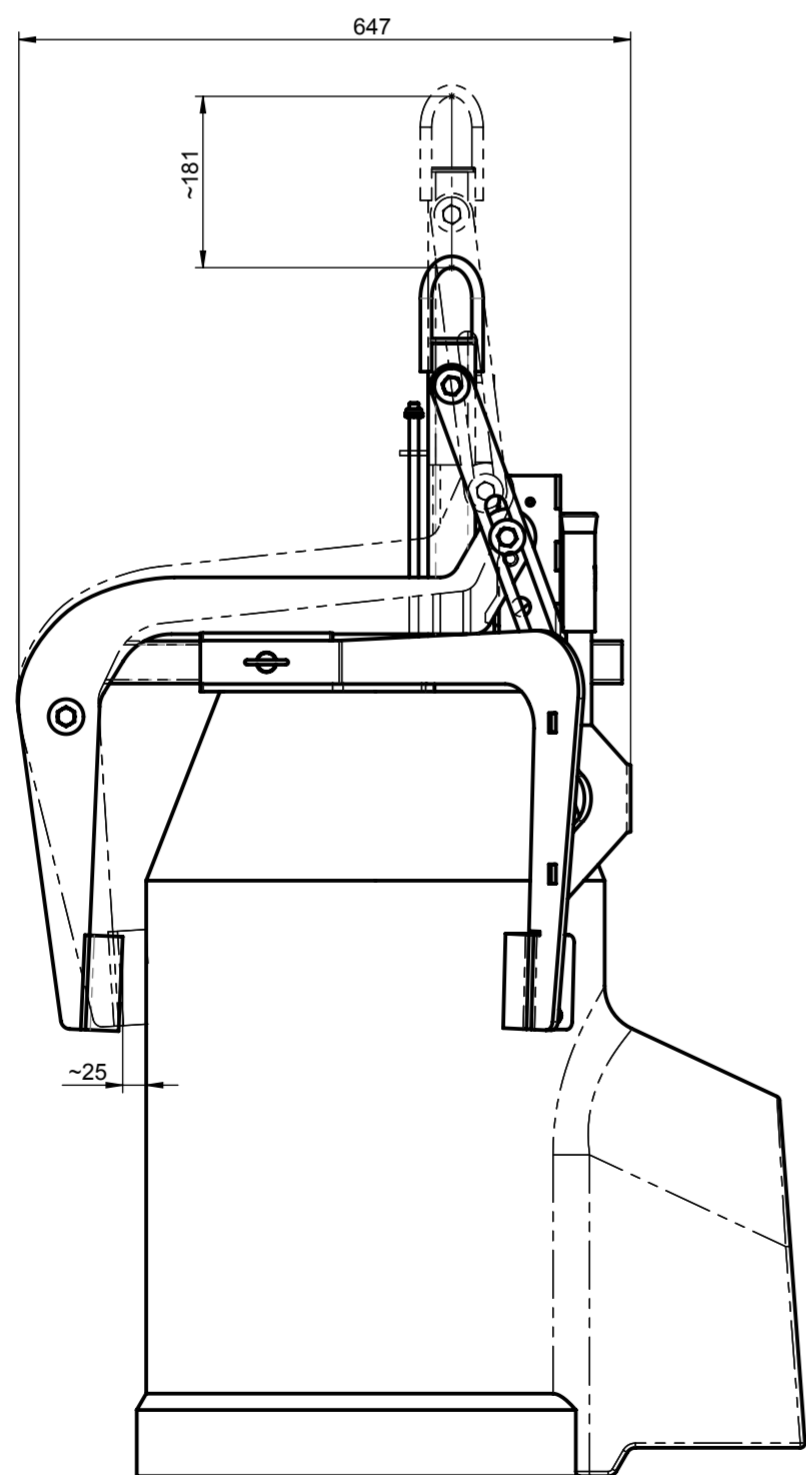
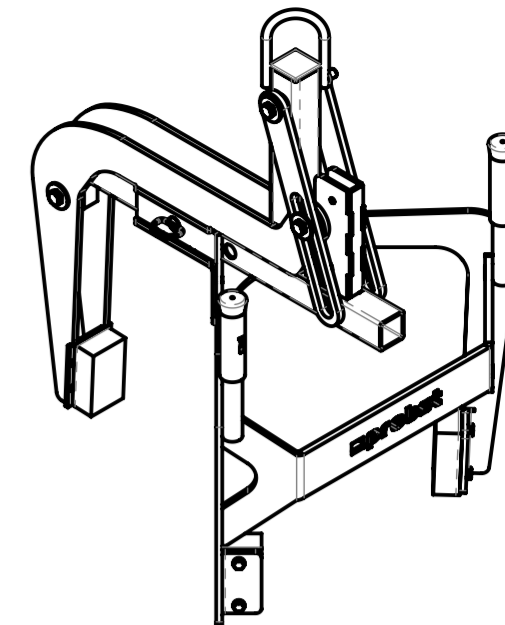
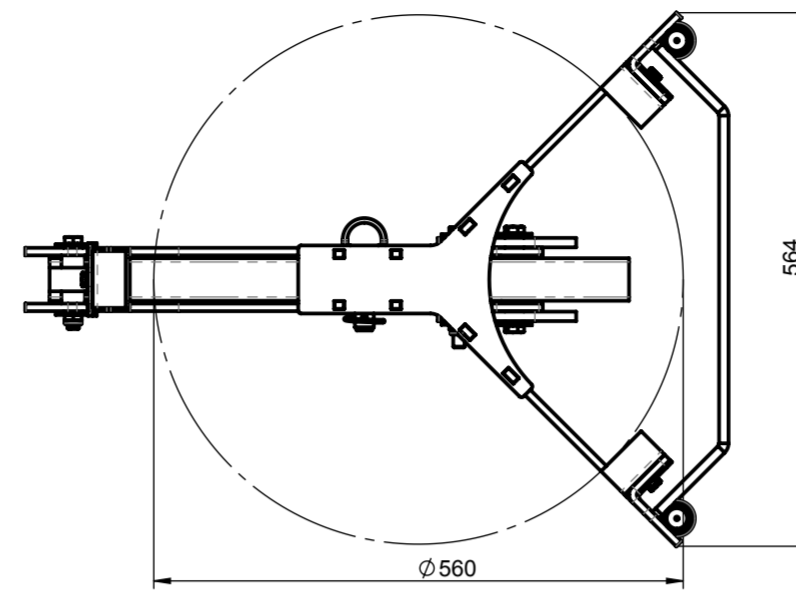
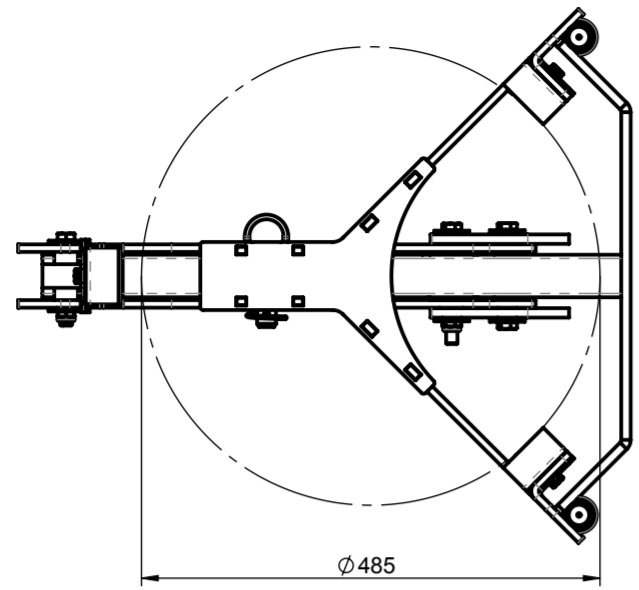

Tragfähigkeit / Working Load Limit WLL:
300 kg / 660 lbs

Eigengewicht / Dead Weight:
33 kg / 73 lbs

Product Name:
Mechanical Grab Gully-Lifter



© all rights reserved conform to ISO 16016

Datum	Name	Benennung
Erst. 26.1.2016	R.Wolff	Mechanischer Greifer
Gepr. 17.2.2016	R.Wolff	Gully-Lifter
		Zum greifen von auf dem Kopf
		stehenden Töpfen
		Artikelnummer/Zeichnungsnummer
		D54000038
Zust.	Urspr.	Ers. f.
		Ers. d.

Blatt
1
von 1

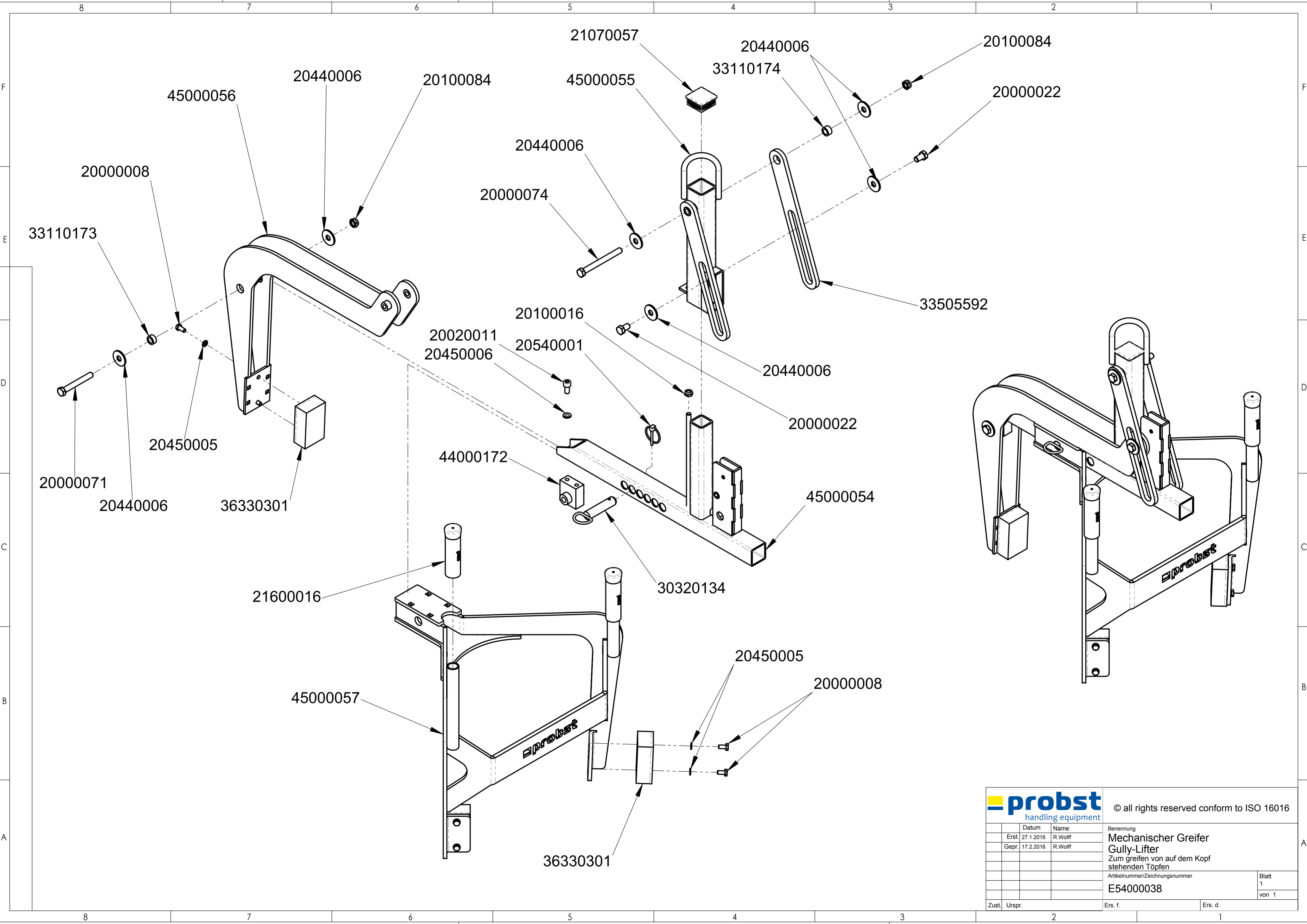

		© all rights reserved conform to ISO 16016	
	Datum	Name	Benennung
	Erst. 27.1.2016	R. Wolff	Mechanischer Greifer
	Gepr. 17.2.2016	R. Wolff	Gully-Lifter
			Zum greifen von auf dem Kopf stehenden Töpfen
			Artikelnummer/Zeichnungsnummer
			E54000038
Zust.	Urspr.	Ers. f.	Ers. d.
			Blatt 1 von 1

Proof of maintenance

Warranty claim for this machine only apply for performance of the mandatory maintenance works (by an authorised specialist workshop)! After each completed performance of a maintenance interval the included form must be fill out, stamped, signed and send back to us immediately ¹⁾.

1) via e-mail to service@probst-handling.de / via fax or post

Operator: -----

Device type: -----

Article -No.: -----

Device-No.: -----

Year of make: -----

First inspection after 25 operating hours

Date:	Maintenance work:	Inspection by company:
		Company stamp
	
		Name Signature

All 50 operating hours

Date:	Maintenance work:	Inspection by company:
		Company stamp
	
		Name Signature
		Company stamp
	
		Name Signature
		Company stamp
	
		Name Signature

Minimum 1x per year

Date:	Maintenance work:	Inspection by company:
		Company stamp
	
		Name Signature
		Company stamp
	
		Name Signature

Proof of maintenance

Warranty claim for this machine only apply for performance of the mandatory maintenance works (by an authorised specialist workshop)! After each completed performance of a maintenance interval the included form must be fill out, stamped, signed and send back to us immediately ¹⁾.

1) via e-mail to service@probst-handling.de / via fax or post

Operator: -----

Device type: -----

Device-No.: -----

Article -No.: -----

Year of make: -----

First inspection after 25 operating hours

Date:	Maintenance work:	Inspection by company:
		Company stamp
	
		Name Signature

All 50 operating hours

Date:	Maintenance work:	Inspection by company:
		Company stamp
	
		Name Signature
		Company stamp
	
		Name Signature
		Company stamp
	
		Name Signature

Minimum 1x per year

Date:	Maintenance work:	Inspection by company:
		Company stamp
	
		Name Signature
		Company stamp
	
		Name Signature

Proof of maintenance

Warranty claim for this machine only apply for performance of the mandatory maintenance works (by an authorised specialist workshop)! After each completed performance of a maintenance interval the included form must be fill out, stamped, signed and send back to us immediately ¹⁾.

1) via e-mail to service@probst-handling.de / via fax or post

Operator: _____

Device type: _____

Device-No.: _____

Article -No.: _____

Year of make: _____

First inspection after 25 operating hours

Date:	Maintenance work:	Inspection by company:
		Company stamp
	
		Name Signature

All 50 operating hours

Date:	Maintenance work:	Inspection by company:
		Company stamp
	
		Name Signature
		Company stamp
	
		Name Signature
		Company stamp
	
		Name Signature

Minimum 1x per year

Date:	Maintenance work:	Inspection by company:
		Company stamp
	
		Name Signature
		Company stamp
	
		Name Signature