



Lightweight Davit Instructions

30m Man Riding Winch

30m Man Riding Winch designed for use in a wide variety of confined space, work positioning, rescue and fall protection applications.

The winch may also be used in various material handling applications within the prescribed working load limits.

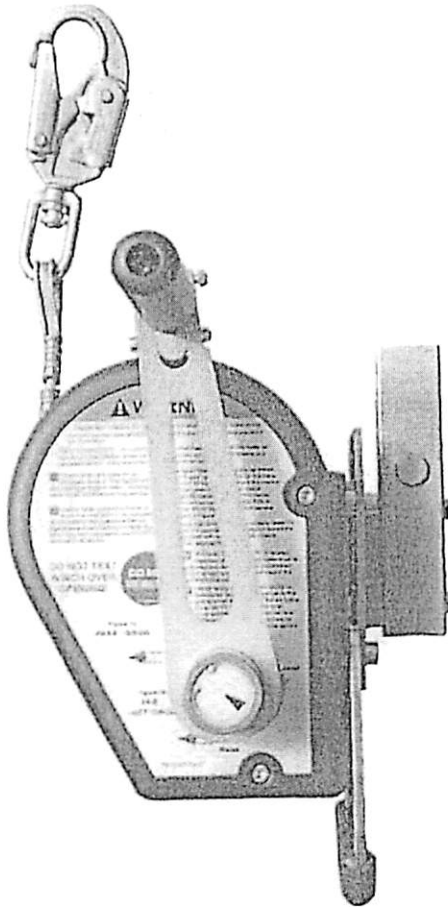

Product Code:
60005

Conformance :
BS EN 795, BS EN 1496

Mechanical Advantage:
11:1

Average Cranking Force:
30LBS (133N)

Secondary Brake Stopping Distance:
Maximum of 24" (610mm)

Max User Weight
(single reeved system):
140KG

Max User Weight
(double reeved system):
280KG

Weight:
15KG

Service Interval:
6 months

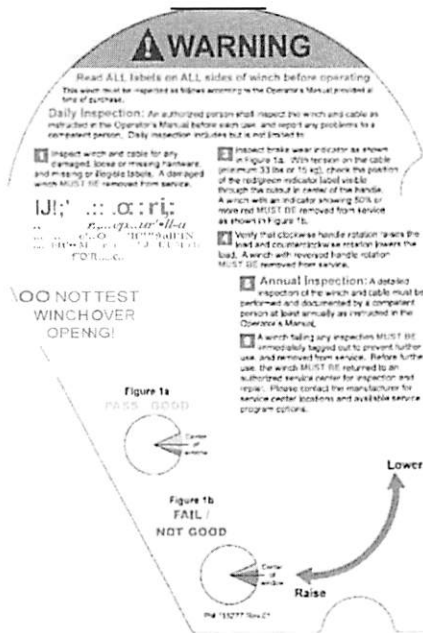

Daily Inspection Instructions

Any problems must be reported immediately to your supervisor, and the equipment labeled so as to prevent further use until it has been repaired.

ATTACHING A WORKER TO THE WINCH LINE

Any worker who is connected to this winch MUST wear a full body harness designed, tested, and approved for fall arrest. The winch line MUST be connected to the dorsal (rear) D-Ring on the harness, unless otherwise instructed by a qualified person.

Extend sufficient winch line to allow the line to be easily attached to the worker's dorsal D-Ring. Be sure to maintain sufficient tension in the line to prevent "bird-nesting" of the winch line.

Attach the winch line to the worker's dorsal D-Ring, making sure that the snap hook operates smoothly and fully locks when attached.

Retract the winch line until the line is snug, and have the worker slowly lift their feet off the ground to verify system integrity.

DO NOT TEST SYSTEM INTEGRITY OVER AN OPENING OR WHERE THERE IS A CHANCE OF FALLING.

RAISING OR LOWERING A WORKER

A worker attached to the winch line is lowered by cranking the winch handle counterclockwise, and raised by cranking the winch handle clockwise. DO NOT use the winch if the rotation of the winch handle is reversed, or if the winch does not make a regular clicking sound when cranking the winch handle in a clockwise direction.

Crank the handle at a smooth and steady pace that you find comfortable to maintain.

Wear gloves if your hands will come in contact with the winch line.

Maintain sufficient tension on the winch line, either from the weight of the worker or manually, to ensure that the line winds evenly onto the spool. Do not allow any slack line to accumulate between the winch and the worker if there is any risk of a fall occurring. Serious injury or death may result if a worker falls while connected to a slack winch line.

Lower Davit

Large Lower Davit.
To be used with an Upper Mast Davit
and Base

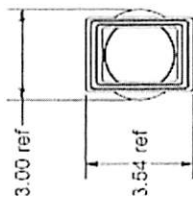
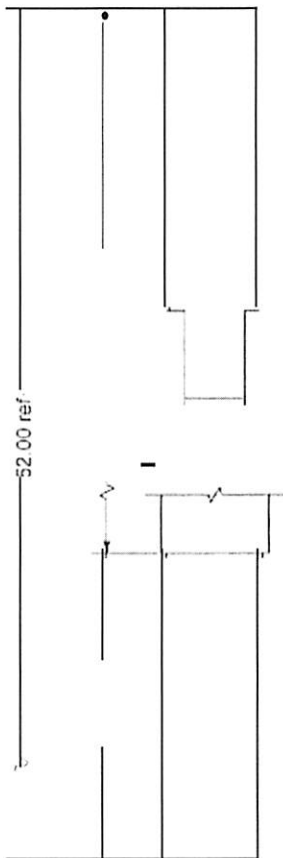

Product Code:
30109

Contormance:
BS EN 795 TYPE B

Weight:
8kg

Height:
52"
(1321mm)

Upper Davit

Large Upper Davit, with an adjustable offset.
To be used with a Lower Davit and Base

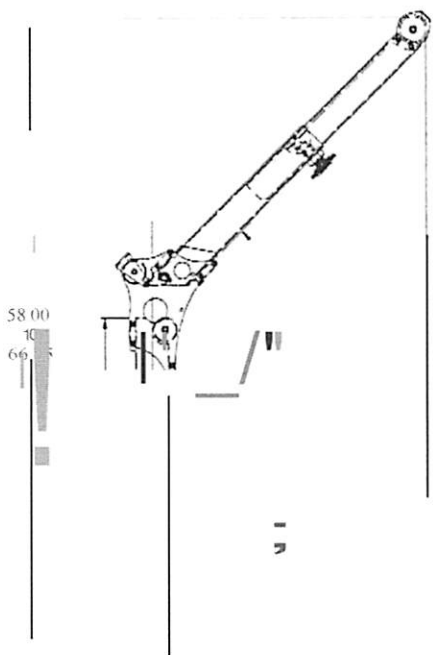
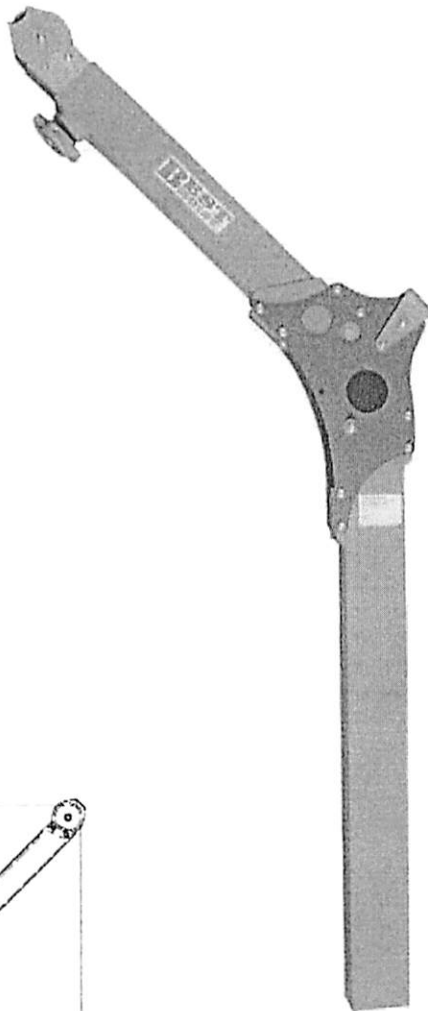

Product Code:
30105

Conformance:
BS EN 795 TYPE B

Weight:
12kg

Reach:
19.5" to 29"
(495mm to 737mm)

Height:
58" to 67"
(1473mm to 1702mm)

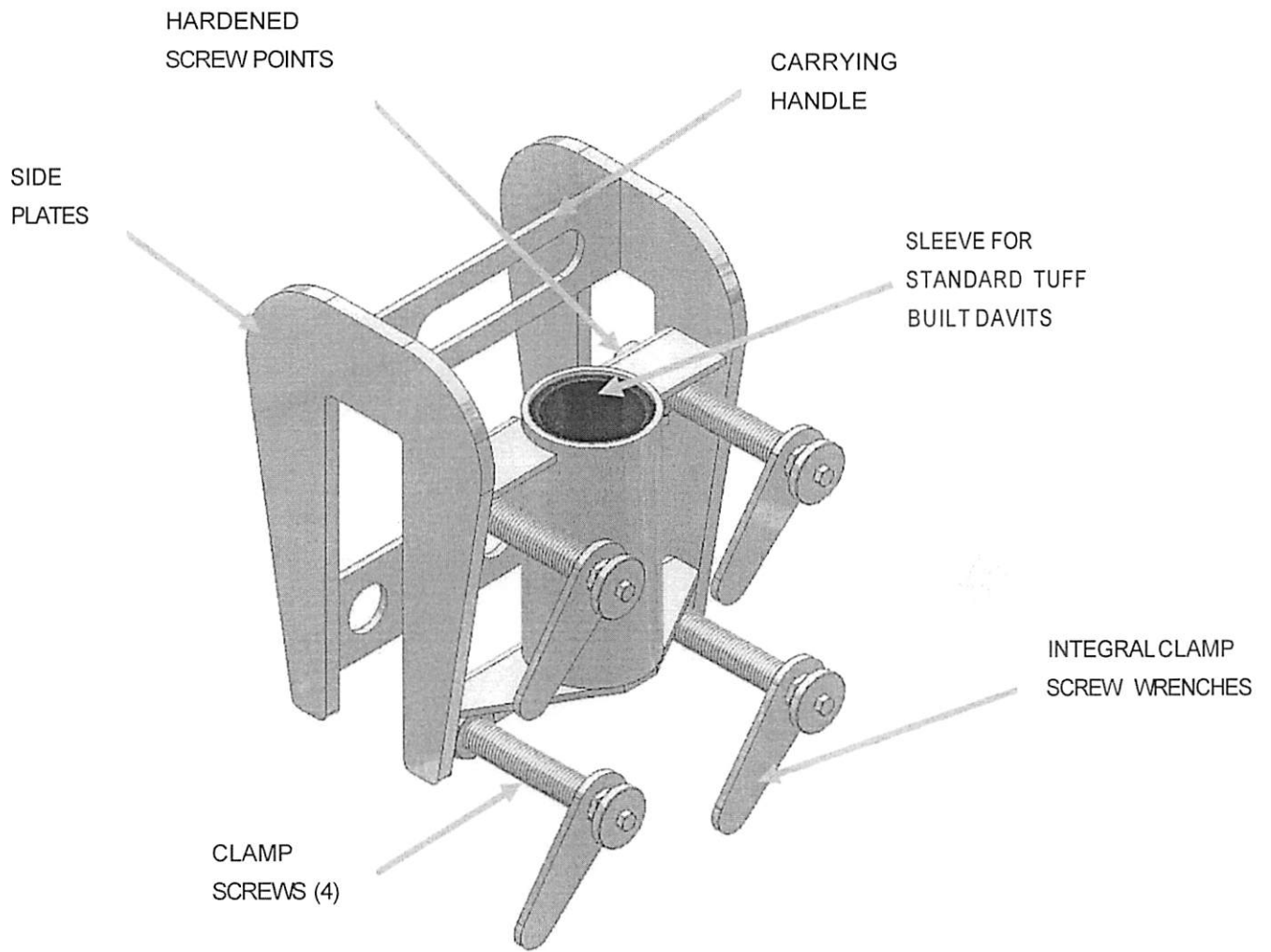

The Barrel Mount must be inspected before each use.

Any problems must be reported immediately to your supervisor, and the equipment labeled so as to prevent further use until it has been repaired.

Install the Barrel Mount Sleeve over an approved supporting structure as shown in Figure 2 below. Tighten Clamps Screws securely using the integral wrenches provided. Do not use larger tools or any kind of an extension on these wrenches.

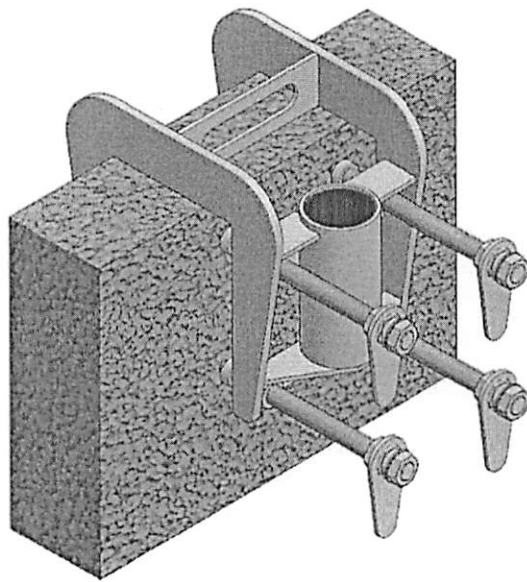

Figure 2, Attaching Typical Barrel Mount Sleeve to Supporting Structure.

Install the Davit and any other system accessories following the appropriate manufacturer's instructions supplied with the equipment.

SYSTEM OPERATION

Once the equipment has been installed as described above, proceed with the work at hand following approved procedures.

TRAINING

Any worker using the Barrel Mount must receive appropriate training from their employer on all equipment and procedures involved prior to operating. Users must fully read and understand this manual and any other instruction manual(s) related to the system being used, or have the instructions explained to them, before using this equipment.

DAILY INSPECTION

The Barrel Mount must be cleaned and inspected before each. Report any problems or concerns to your supervisor, and do not use the equipment until they have approved doing so.

Cleaning and Lubrication

If required, clean and lubricate the Barrel Mount and all its parts. Do not use solvents or other chemicals to clean the base.

Physical Damage

Inspect the Barrel Mount and all accessories for physical damage; bent parts, loose or missing hardware or parts.



Fareham 01329 828082

Uckfield 01825 744052

www.promechhire.co.uk