

PRODUCT CODE: EA012

PRODUCT DESCRIPTION: QUICK HITCH PIPE LIFTER

PRIMARY FUNCTION: FOR SAFE MOVEMENT AND PLACEMENT OF PIPES

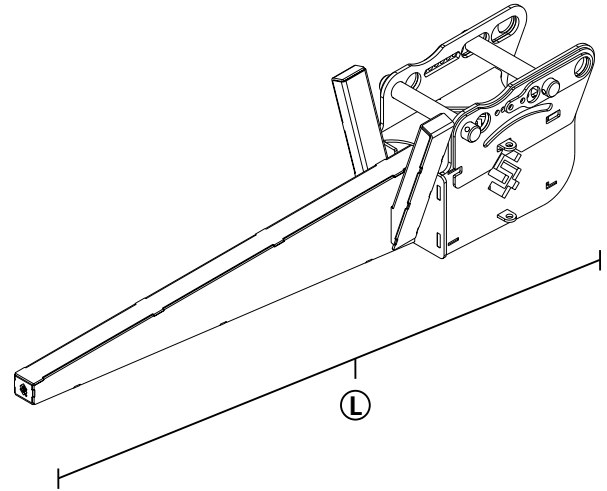

Excavator Pipe Lifter for use with quick hitch or direct to excavator

- 4t WLL
- Pipe insertion pusher heels
- Adjustable pin centres fit most excavators
- 65mm and 80mm pins
- 2.5m pipe length capacity
- 1.8m beam length capacity

WLL. Kg	H mm	W mm	L mm	Wt. Kg	Beam L mm	Cap mm
2000	650	500	2400	230	1500	2000
4000	650	500	2700	300	1800	2500

BASIC SAFETY

IMPORTANT: Read these instructions before using this equipment. If there is anything you do not understand or if you have any concerns **DO NOT** use this equipment. Contact your supervisor or Conquip for advice.

You should check that you have considered all the safety requirements for the task you are doing and that this equipment is suitable.

You must protect bystanders and the general public by preventing access to the working area.

DO NOT use this equipment if you are tired, unwell or under the influence of alcohol or drugs. If you are taking any medicine or undergoing treatment you should inform your supervisor.

You must be competent, alert and medically fit when using this equipment. If you have a medical condition, a mental or physical disability, you must seek advice from a medical professional before using this equipment.

A **RISK ASSESSMENT** must be completed by a competent person before using this equipment to control risks, produce a safe system of work and ensure safety for you, your colleagues and others.

Your risk assessment will determine the correct Personal Protective Equipment (PPE) for the task you are doing. You **MUST** use it.

Conquip recommends that you should wear:

- Suitable Clothing
- Gloves
- Hard Hat
- Protective Footwear (steel toecaps)



DO NOT wear loose clothing or jewellery and tie back long hair to avoid becoming tangled or trapped in this equipment. You **MUST** make everyone in the work area aware of what you are doing. **NO SURPRISES.**

This equipment should be operated, stored and transported upright.

Make sure you know how to use this equipment and understand all aspects of its operation in case of emergency. This equipment weighs more than 25 kg. **DO NOT** lift or manhandle without machine assistance.

This equipment must be inspected by a competent person before use and then regularly, as determined by your risk assessment or working practice. If you have any concerns about condition or suitability **DO NOT USE.**

DO NOT operate this equipment near overhead power lines.

TAKE CARE in confined spaces, near ceilings or similar hazards. This equipment was designed for vertical lifting. **DO NOT** drag, tilt or swing.

Before lifting, check that the load is balanced and stable. Keep all personnel clear of raised loads and far enough away to allow for movement caused by a shifting load.

CRUSH RISK. Keep hands and feet clear of this equipment at all times to avoid injury.

DO NOT LEAVE UNATTENDED. The operator must remain in control of this equipment whenever it is loaded.

Before lowering a load make sure that the landing zone is clear

and capable of accepting the size and weight of the load.

Total weight of the equipment plus the load must not exceed 50% of the forklift WLL.

Manoeuvre loaded of raised equipment carefully. Travel and turn slowly to avoid unit becoming unstable.

Please distribute the load in this equipment evenly.

DO NOT exceed the maximum working load limit shown on the serial plate.

Before lifting, forks must be fully engaged and the security chain or heel pins **MUST BE** correctly fitted.

HEAD, HANDS & FEET must be kept clear.

Trucks used for lifting and moving this equipment must be capable of lifting the equipment and its load.

DO NOT exceed **WORKING LOAD LIMIT.**

Before operating this equipment make sure that the working area is clear of hazards, obstructions and personnel.

Check that the equipment has the correct load rating and dimensions for the intended load.

Before operating this equipment, check that you have enough space for you to work safely. Allow space for the equipment to move if the load shifts.

PREPARATION

Ensure the work area is clear of all obstructions.

Ensure adequate room around the unit for the operator to work safely.

The quick hitch pipe lifter is designed to enable an excavator to offload and transport concrete pipes on site.

Maximum load capacity is 2000/4000 kg according to version. Do not exceed this maximum load.

The lifting arms are 1.5m and 1.8m in length and can lift pipes up to a maximum length of 2m and 2.5m respectively.

It can be used to replace traditional slinging methods so reduces or eliminates the need for additional operatives working at height on the load deck of a delivery vehicle.

Before using this attachment refer to your risk assessment and safe system of work. Controls should be in place for the safe use of lifting equipment and excavators. Personnel other than the excavator driver should be excluded from the working area. If there is a banksman he/she should not be positioned underneath the load and should remain visible to the driver.

Refer to the operating guidelines for the excavator and the quick hitch that you are using.

Operators must be competent to use this fork attachment.

SET UP

- Check that quick hitch is securely attached to the excavator arm following the manufacturers' instructions and giving special attention to any safety features.
- Check that the attachment has been thoroughly examined and is certified according to the Lifting Operations and Lifting Equipment Regulations 1998.
- Select correct pins for your machine's quick hitch.
- Fit front pin to correct sized hole on the pallet fork attachment.
- Adjust position of rear pin to suit the quick hitch – follow the quick hitch operating guidelines and set the pins to the maximum centres for the unit.

POWERED BY KNOWLEDGE

- Ensure the quick hitch pins have the retaining bolts correctly fitted.
- Check for debris in the quick hitch locking mechanism.
- Check the fit of the unit on the quick hitch, do not use if not secure.
- Inspect the pipe lifter to ensure it is in good condition and routinely check the entire unit for damage, cracked welds, twisting, missing bolts etc.
- The working area should be firm and level.
- When moving pipes or similar round items operators should be aware that they might roll and should have a method of securing the pipes prepared.
- When travelling with a load: keep it in the lowest practicable position, maintain driver visibility, and tilt the pipe lifter back by 10 to 20 degrees to secure the pipe on the boom.
- Operators should allow for any rough or sloping ground when assessing the method of operating.

FINALLY

Carefully lower the pipe onto the ground or storage location, take care of edges or other special features on hard ground. Use suitable measures to prevent the pipe from rolling.

EQUIPMENT MAINTENANCE AND CLEANING

When not being used, store the unit in a clean condition and in a safe place where it will be protected from thieves and unauthorised users.

TO LIFT A PIPE

- When it is safe to proceed, raise the pipe lifter until the tip is just below the crown then fully insert the boom into the bore as straight as possible and slightly tilted back.
- Lift the boom carefully and level it so that it fully contacts the crown.
- Lift the pipe clear of the delivery vehicle or ground etc.

NOTE: FAILURE TO CLEAN THIS EQUIPMENT THOROUGHLY MAY RESULT IN A CHARGE.



WARRANTY

Conquip Engineering Group products are covered by a 12 month warranty. Conquip Engineering Group undertakes to replace or repair, free of charge, any defect which the Company considers to be due to faulty workmanship or material within 12 months of the sale date, except for:

Defects arising from neglect, misuse or unauthorised modifications.

Damage caused by abuse, misuse, dropping or other similar damage caused by or as a result of failure to follow transportation, storage, loading, cleaning or operation instructions.

Alterations, additions or repairs carried out by persons other than Conquip Engineering Group or their recognised distributors. Transportation or shipment costs to and from Conquip Engineering Group or their recognised agents, for repair or assessment against a warranty claim, on any product or component.

Materials and/or labour costs to renew, repair or replace components due to fair wear and tear.

Faults arising from the use of non-standard or additional parts, or any consequential damage or wear caused by the fitting or use of such parts.

Conquip Engineering Group and/or our recognised agents, directors, employees or insurers will not be held liable for consequential or other damages, losses or expenses in connection with, or by reason of, or the inability to use the product for any purpose.

MODIFICATIONS

If any third party work, modifications or alterations are to be carried out on the product which will involve any welding, drilling or any form of cutting or distortion of materials, full written approval must be obtained from Conquip Engineering Group prior to the work being carried out.

Conquip Engineering Group operate a policy of constant improvement and reserve the right to change specifications without notice.

ITEM NO	PART NUMBER	DESCRIPTION	QTY
1	ZZ130039	65mm pin	2
2	ZZ130040	80mm pin	2

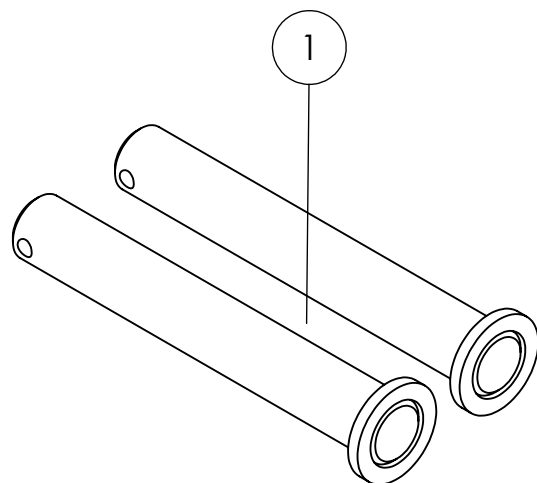
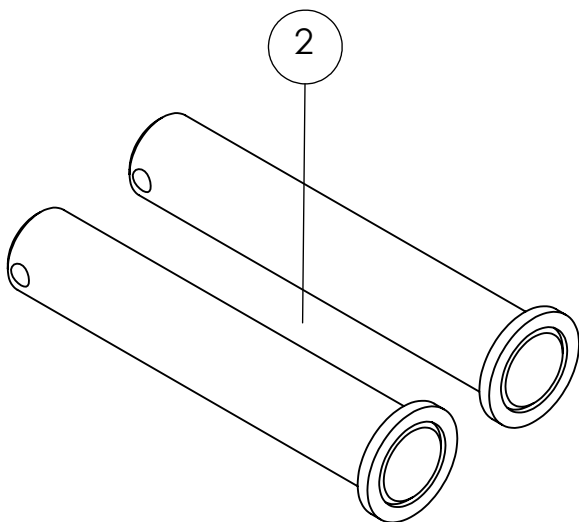
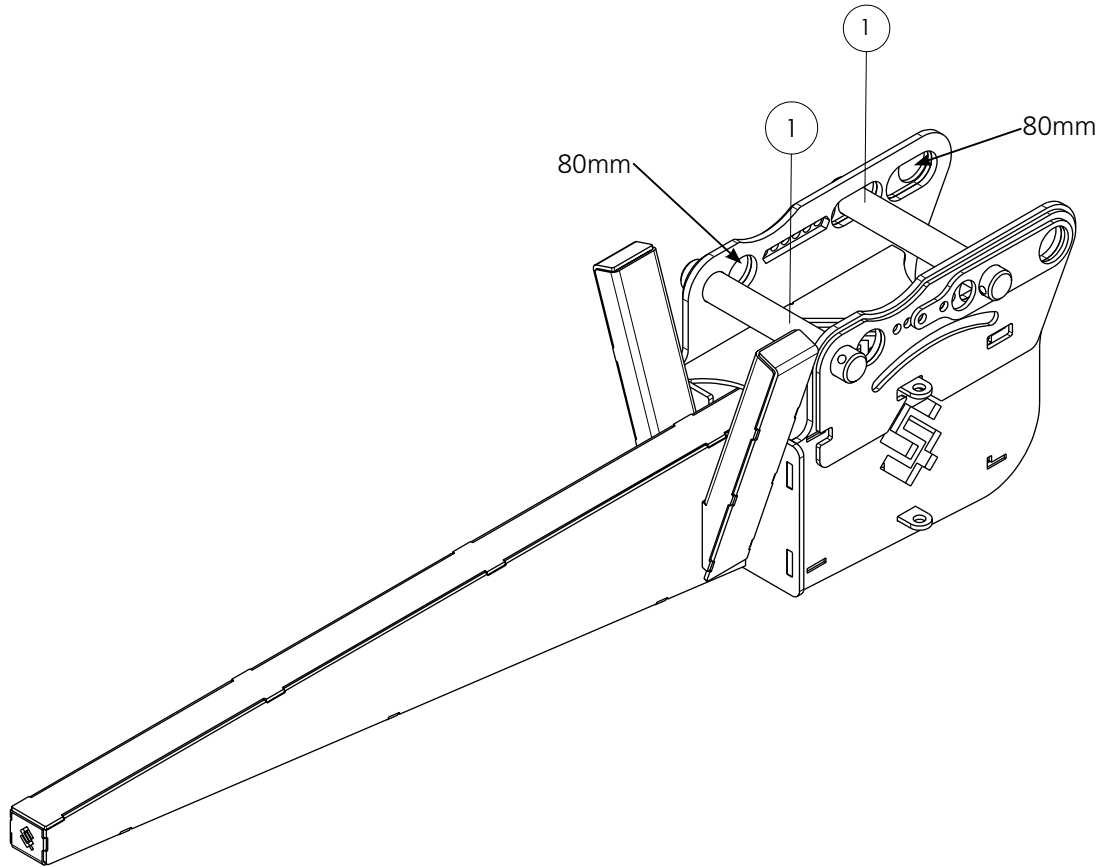

© 2014 Conquip Engineering Group

TO ORDER CALL 0845 520 1101



CONQUIP ENGINEERING GROUP | WATERBROOK ESTATE, ALTON, HANTS, GU34 2UD